



Pittsburgh **PARKING** Authority

The Value Parking Network

GENERAL INFORMATION REGARDING THE FIRST AVENUE GARAGE

600 FIRST AVENUE, PITTSBURGH, PA 15219

The First Avenue Garage is a six-level parking structure opened in May 2001.

The garage has four flat parking bays and one non-parking ramped bay.

The capacity of the parking garage is 1,243 vehicles.

The structural system varies slightly within the facility.

The parking bays utilize pre-cast, pre-stressed concrete double tee floor panels with a cast-in-place concrete topping supported by pre-cast, pre-stressed concrete beams and pre-cast, conventionally reinforced concrete columns and walls.

The parking ramp utilizes pre-cast, pre-stressed concrete shallow quad-tee panels supported by pre-cast, conventionally reinforced concrete walls.

Total area of garage:	430,644 sf
Typical floor area:	71,774 sf
Maximum dimensions:	278' x 258'
Typical bay dimensions:	62'-0" x 34'-0"
Architectural shape:	Rectangular
Year opened:	2001
Number of levels:	5 structurally supported + 1 slab-on-grade
Total number of spaces in garage:	1,243
Parking on grade:	Yes
Retail space within garage:	No
Below grade parking:	No
Construction type:	Precast concrete with double tee floor panels
Garage functionality:	Flat parking levels with non-parking, two-way ramps
Maximum Clearance Height:	6'6" - 2nd - 7' ft. 1st floor

SEE NEXT PAGE: FIRST AVENUE PARKING GARAGE TYPICAL FLOOR PLAN



Pittsburgh **PARKING** Authority

The Value Parking Network

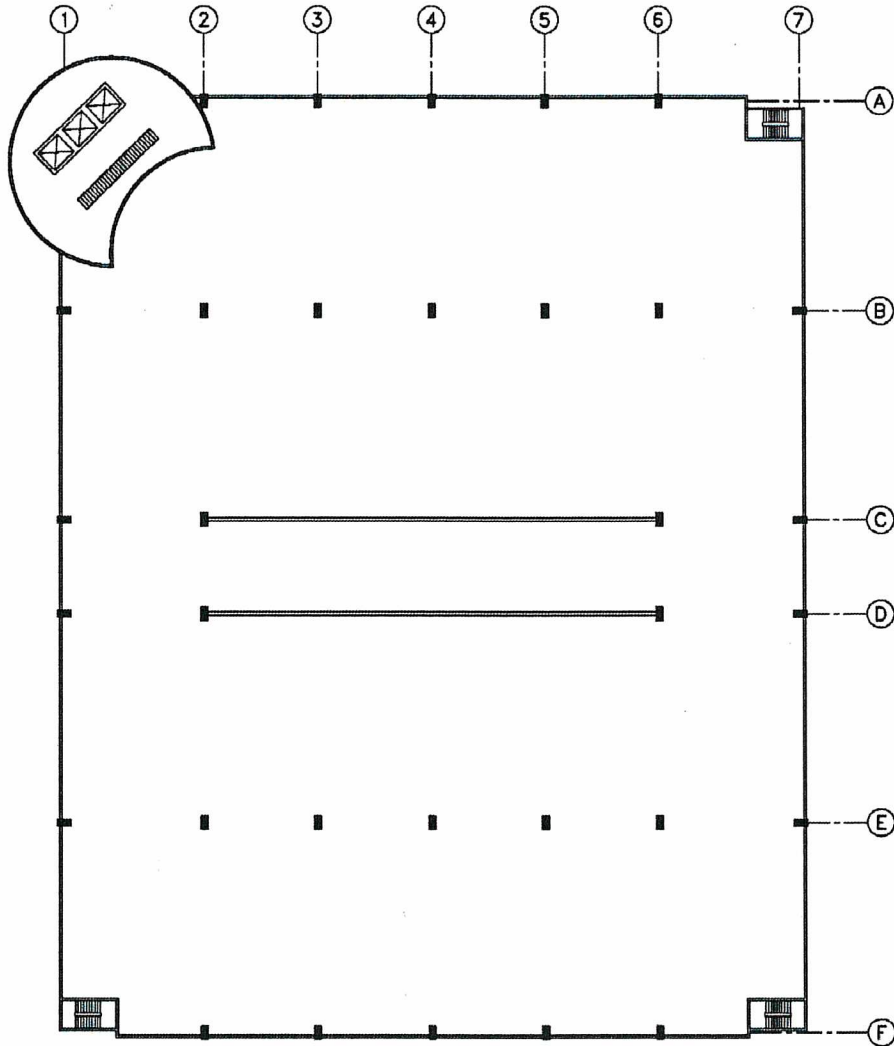

FIRST AVENUE PARKING GARAGE
TYPICAL FLOOR PLAN

