



Pittsburgh **PARKING** Authority

The Value Parking Network

GENERAL INFORMATION REGARDING THE SMITHFIELD LIBERTY GARAGE

629 SMITHFIELD STREET, PITTSBURGH, PA 15222

The Smithfield Liberty Garage is a nine-level parking structure that functions as a single helix with one-way traffic up through the garage and a single threaded helix ramp down to exit.

The Smithfield Liberty Garage has two entrances and exits on both Smithfield Street and Liberty Avenue.

The garage has 616 parking spaces and was opened in 1965.

The structural system utilized in the garage is cast-in-place, conventionally reinforced concrete slabs supported by structural steel beams and columns that are encased in concrete.

The concrete encasement does not serve a structural purpose.

Total Area of garage:	307,338 sf.
Typical Floor area:	34,471 sf.
Maximum Dimensions:	271' x 248'
Typical Bay Dimensions:	Varies
Architectural Shape:	Irregular
Year Opened:	1965
Number of Levels:	8 structurally supported + 1 slab-on-grade
Total Number of Spaces in garage:	616
Parking on Grade:	Yes
Retail Space within garage:	No
Below Grade parking:	Yes
Construction Type:	Cast-in-place, conventionally reinforced slabs, Structural steel beams and columns
Garage Functionality:	One-way single helix with express helix exit ramp
Maximum Clearance Height:	6' ft.

SEE NEXT PAGE: SMITHFIELD LIBERTY GARAGE TYPICAL FLOOR PLAN



Pittsburgh **PARKING** Authority

• *The Value Parking Network*

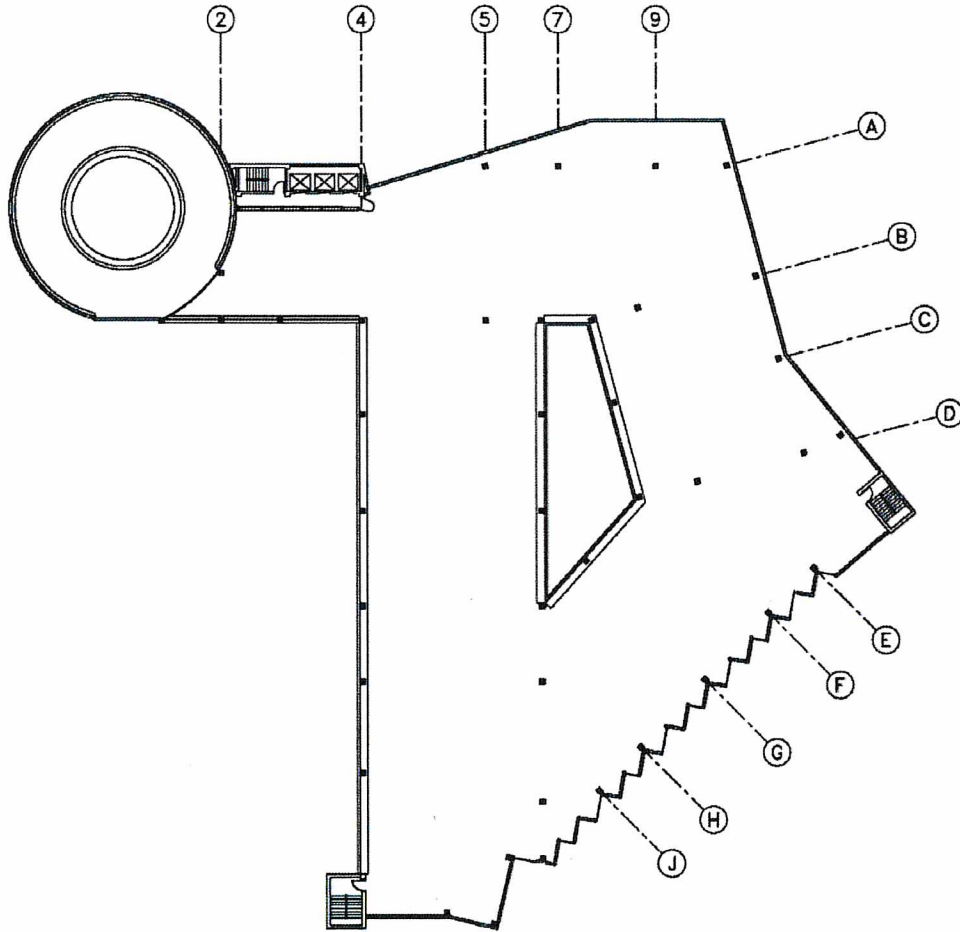

SMITHFIELD LIBERTY PARKING GARAGE ➤➤ N
TYPICAL FLOOR PLAN